

STC Acoustic Sleeper™ Details for Frame Construction

The Acoustic Sleeper system should be installed along with the framing for continuous installation, prior to interior partitions, to avoid cutting of panels in small spaces.

1. Install STC Acoustic Sleeper™ pads on sheathing along the line of structural supports at minimum 24" o.c. and as required for load and desired deflection limits of subfloor panel.
2. Load-bearing partitions and shear walls require a continuous 1/4" high bearing strip between the sheathing and subfloor panels, of plywood or OSB, minimum width to match wall plates, centered on bearing walls and shear walls (Fig. 1).
3. OPTION: Load-bearing partitions may be installed directly on the sheathing (Fig. 2). To minimize cutting, install pads and subfloor panel prior to non-bearing partitions. Pads or strips may be used at perimeter.
4. Install T&G subfloor panel over pads and bearing strips, in thickness as required for loads and spacing. Edge of panels should sit halfway across pads. Fasten through pads into sheathing. Do not fasten except through pads or strips.
5. Location of pads will be evident at leading edges next to nails at previously-laid trailing edges. Pads in field are located at grid lines over structural members. Pads overlap at trailing edges and can be slipped in after the subfloor panel is placed.
6. Non-load-bearing partitions may be installed directly on the subfloor panel with no supplemental support (Fig. 3).

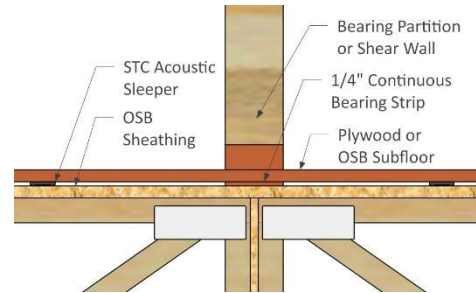

Figure 1: Load-Bearing Partition on Subfloor

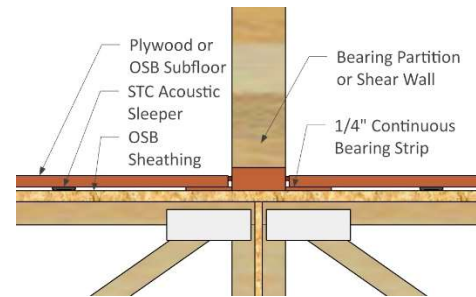

Figure 2: OPTION Load-Bearing on Sheathing

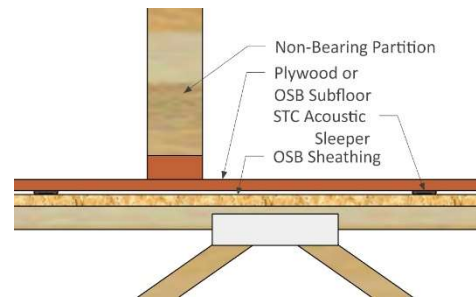

Figure 3: Non-Bearing Partition

Quantity of pads can be estimated based on the structural member spacing and desired spacing along supports.

May 21, 2019

Area per 100 Pads		
Structural Spacing	Pad Spacing	
	16"	24"
16"	133	200
19.2"	152	229
24"	200	266